

**TYPICAL SECTION**  
Scale 1:30

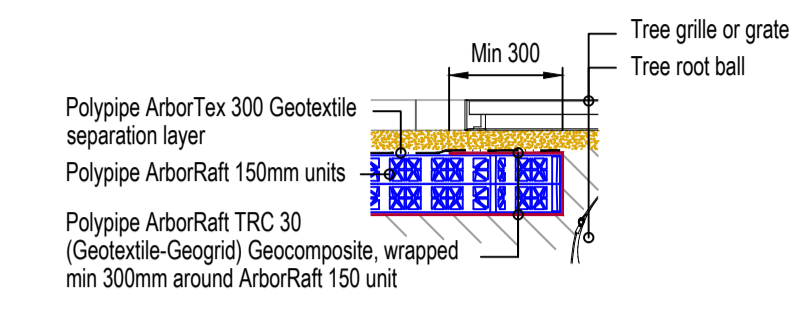

**RAFT EDGE DETAIL  
INNER PERIMETER**  
NTS

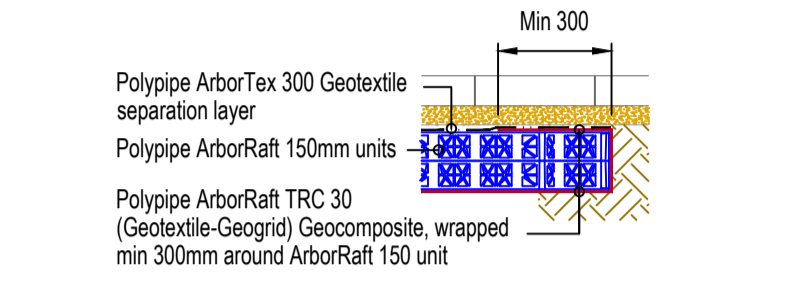

**RAFT EDGE DETAIL  
OUTER PERIMETER**  
NTS

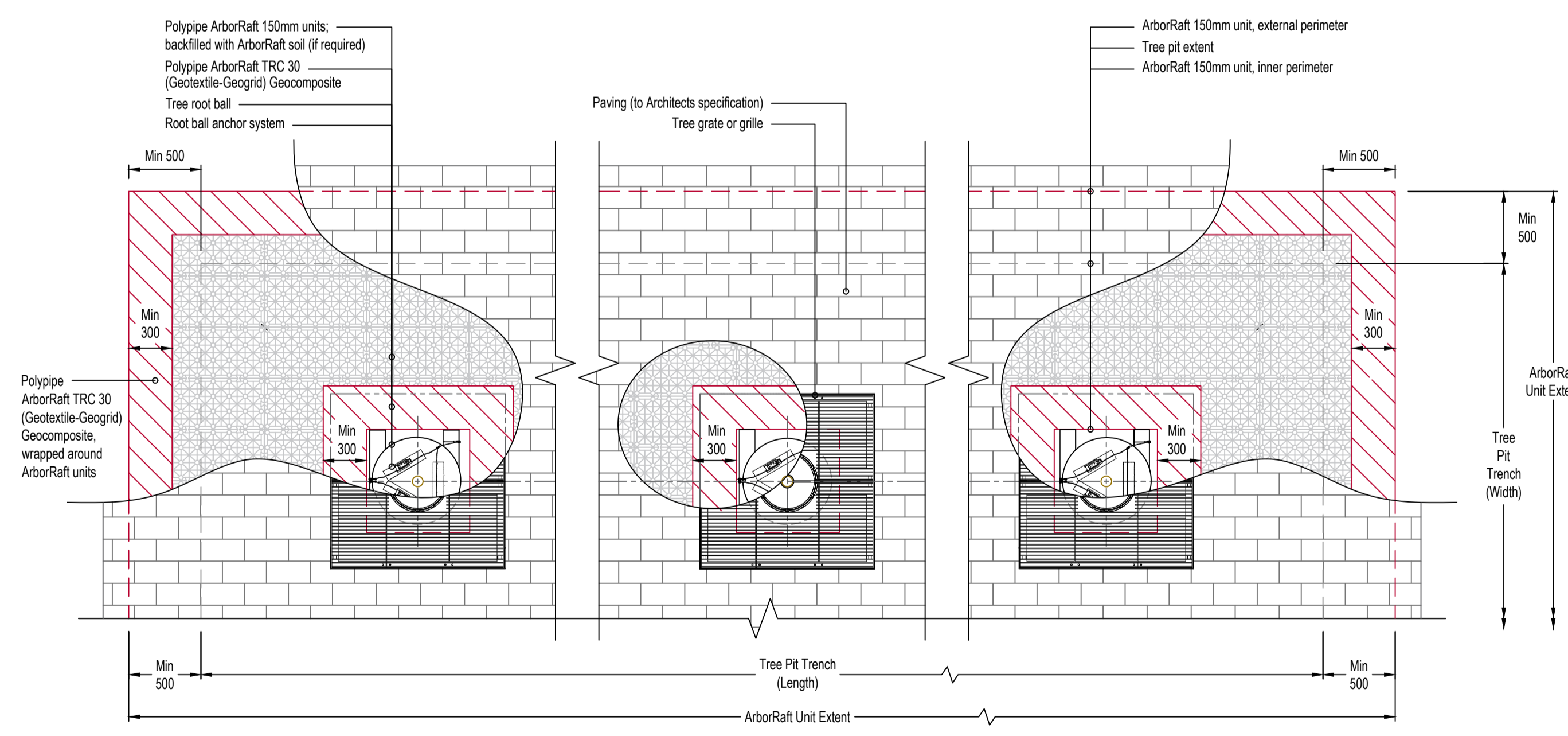

**PLAN VIEW**  
Scale 1:30

- NOTES**
- All dimensions in millimetres, unless otherwise stated.
  - All dimensions are nominal and may vary within manufacturing or construction tolerances.
  - All site temporary and enabling works by others.
  - Polypipe products to be installed in accordance with Polypipe Civils recommendations, giving due consideration to the requirements of the approving organisation(s) and the ultimate owner of the installation.
  - This drawing is intended for guidance only. All proposed installations should be assessed in the context of the site and expected operational conditions, in addition to the overall site drainage scheme, prior to commencement of final design or construction activities.
  - All construction activities shall be executed by competent personnel, in accordance with all relevant legislation, regulations, standards or codes of practice.

REV	A	Minor title amendments	04/03/19
		AMENDMENT	DATE

<p><b>Polypipe</b> Polypipe Civils North Road, Loughborough Leicestershire, LE11 1LE Tel: 01509 615100 Fax: 01509 615215 www.polypipe.com/civils</p>	PROJECT <b>POLYPIPE ARBORRAFT TREE PLANTING</b>	STATUS <b>FOR INFORMATION</b>
	DRAWING TITLE <b>TYPICAL TREE PLANTING TRENCH DETAIL TREE SAND GROWING MEDIA</b>	SHEET NO. 1 of 1
	SCALE NTS	DATE 13/07/2018
	DRAWING NO. IG-AR-SD-TRD-2018	REV. A

All information in this document is of an illustrative nature and is supplied by Polypipe Civils without charge. Polypipe may modify and change the information, products and specifications from time to time for a variety of reasons, without prior notice. Updates will not be issued automatically. This information is not intended to have any legal effect, whether by way of advice, representation or warranty (express or implied). We accept no liability whatsoever (to the extent permitted by law), if you place any reliance on this document you must do so at your own risk. The information within this document should not be solely relied upon to determine the suitability or installation requirements of our products for a proposed application and expected site conditions, expert advice should be sought in this respect.  
Copyright © 2018 Polypipe. All rights reserved. 'Polypipe logo' is a registered trademark of Polypipe. All Polypipe products are protected by Design Right under CDPA 1988.