

TYPICAL PERMAVOID 85mm ATTENUATION STORAGE

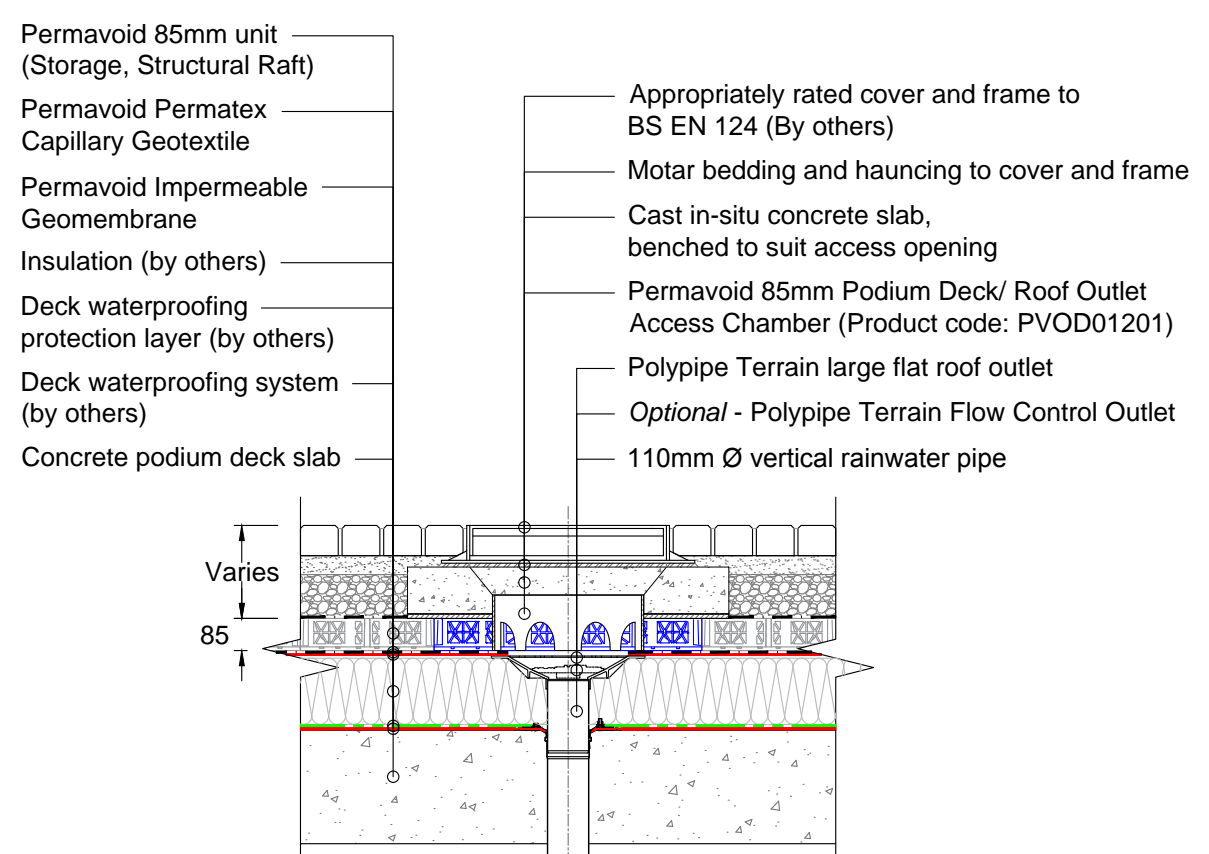

PERMAVOID 85mm PODIUM DECK/ ROOF ACCESS CHAMBER - TYPICAL VERTICAL OUTLET

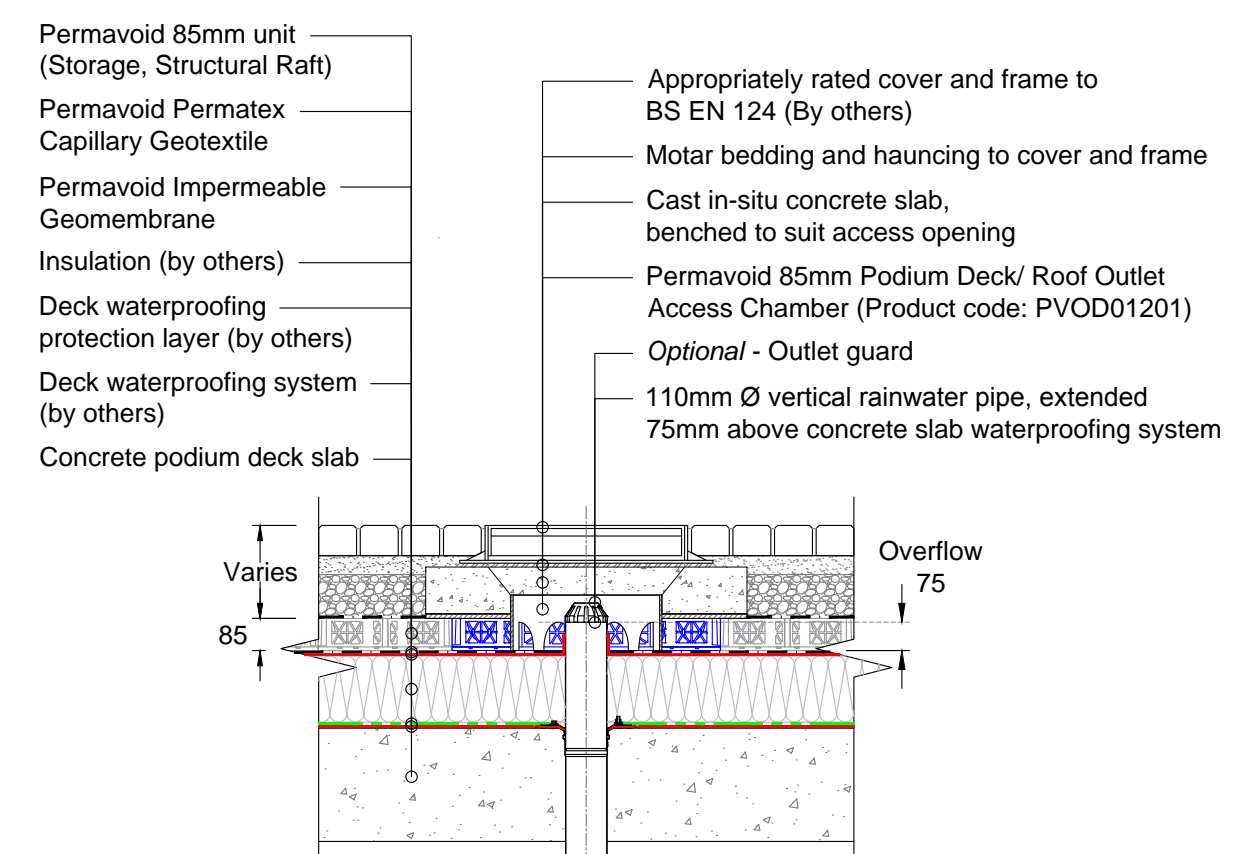

PERMAVOID 85mm PODIUM DECK/ ROOF ACCESS CHAMBER - TYPICAL VERTICAL OVERFLOW OUTLET

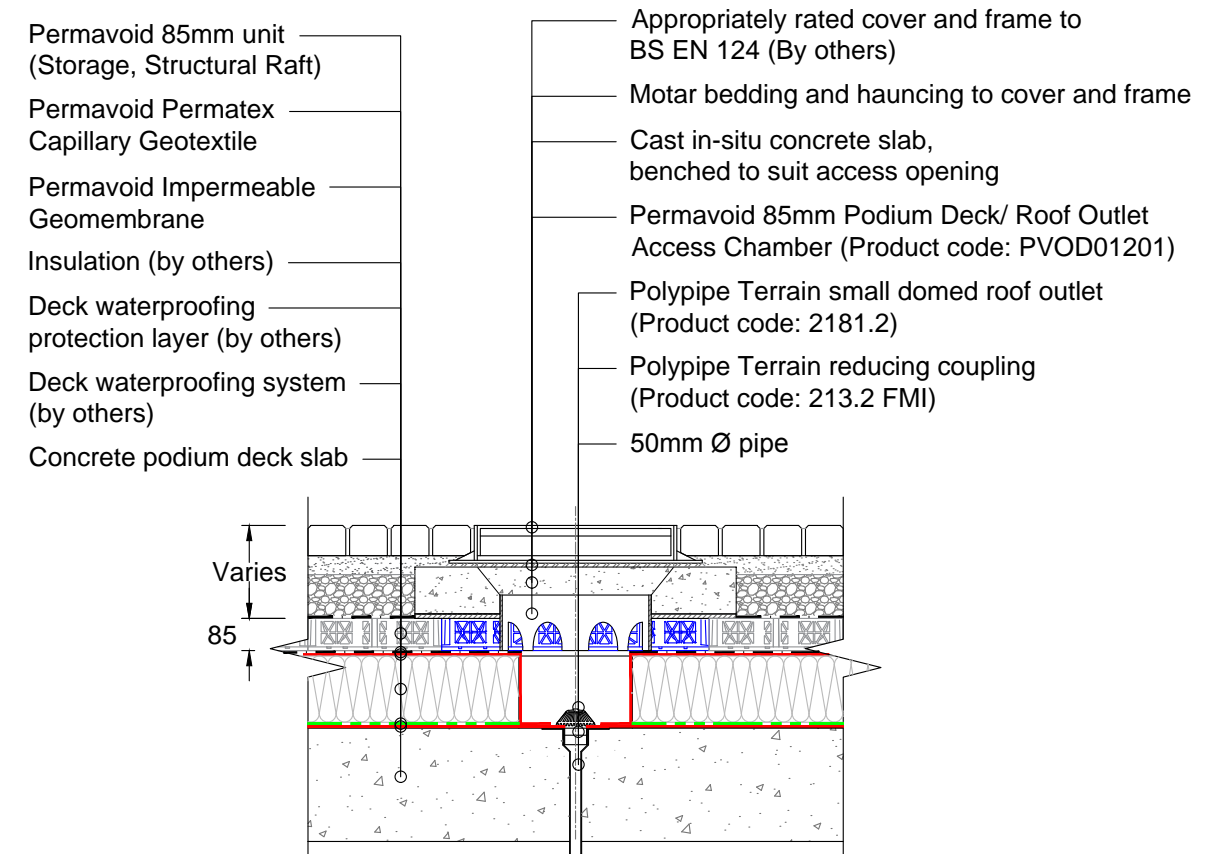

PERMAVOID 85mm PODIUM DECK/ ROOF ACCESS CHAMBER - TYPICAL RAINWATER RECOVERY SYSTEM INLET

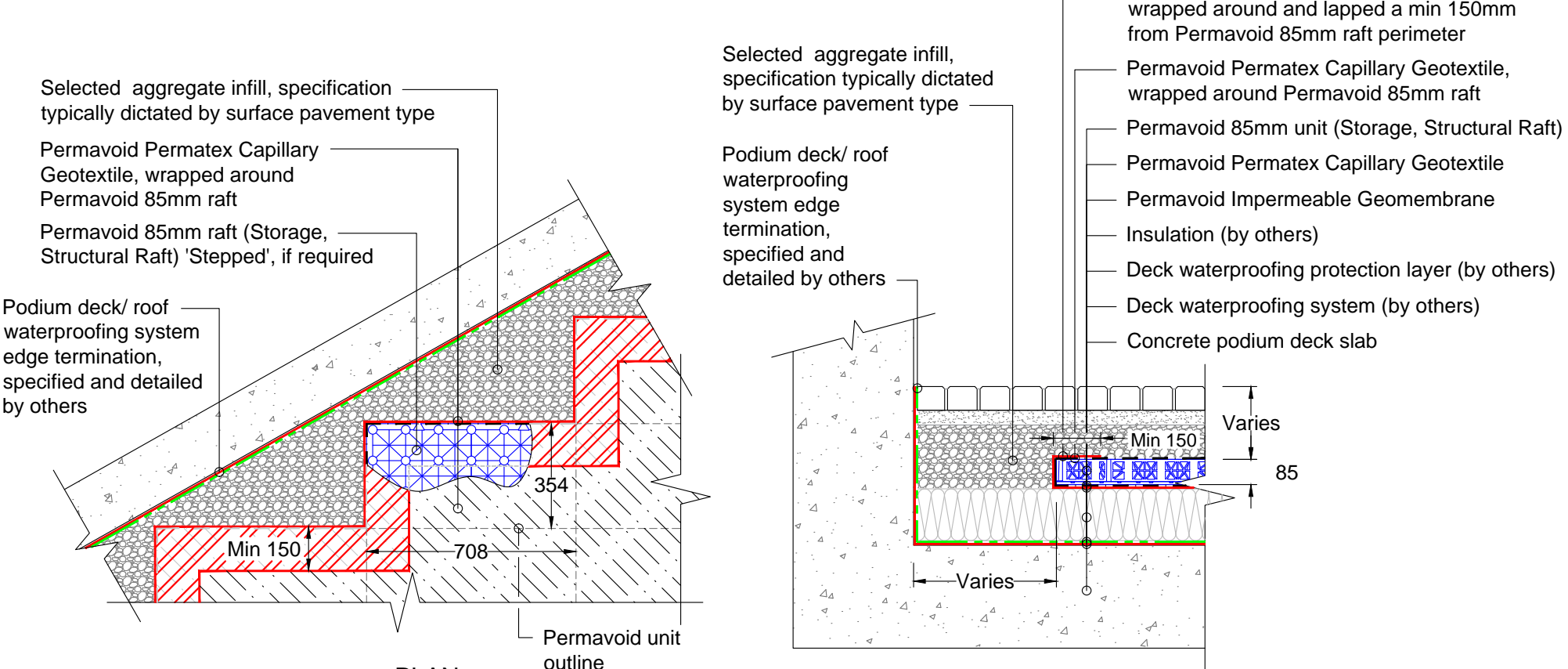

TYPICAL PERMAVOID 85mm RAFT EDGE DETAIL

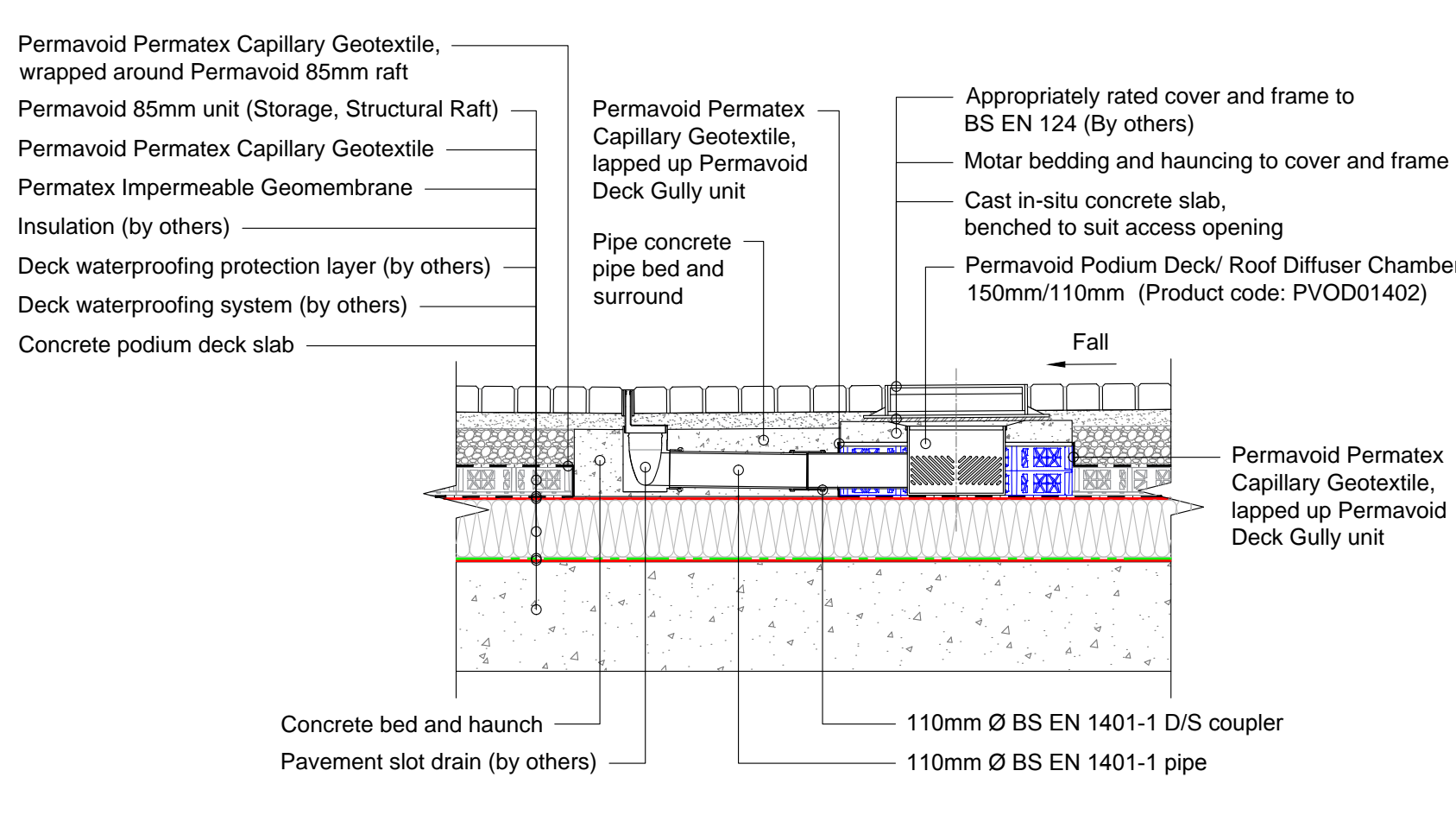

TYPICAL PERMAVOID 85mm PODIUM DECK/ ROOF DIFFUSER CHAMBER - SLOT CHANNEL

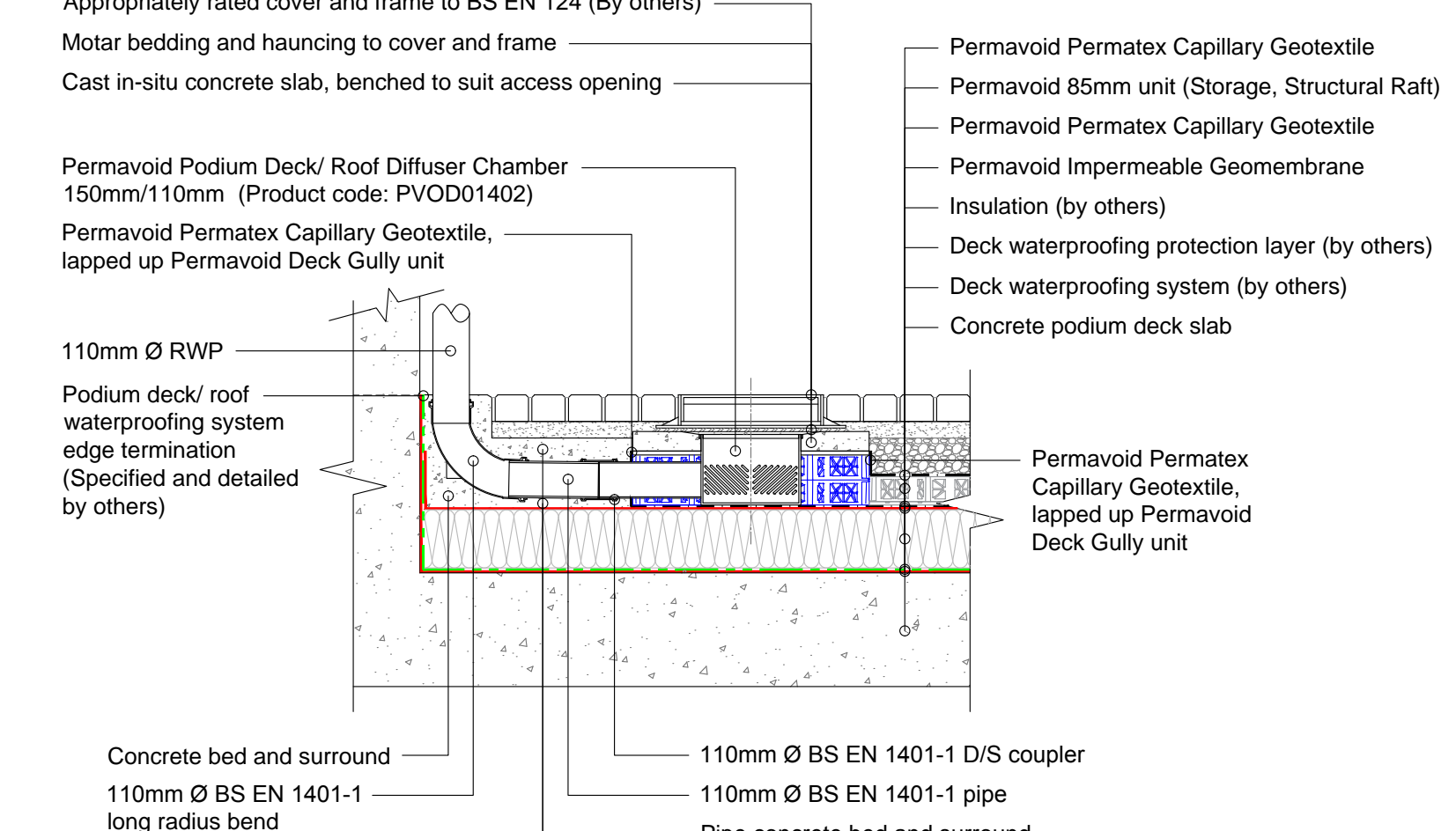

TYPICAL PERMAVOID 85mm PODIUM DECK/ ROOF DIFFUSER CHAMBER - 110mm Ø RWP

**Table 1**  
Coarse Graded Aggregate - Grading Limits  
[Referencing BS EN 7533-13:2009, Annex A]

Standard	BS EN 13242	
	4 / 40	4 / 20 <sup>1)</sup>
Grading (Size) [mm]	Percentage by mass passing	
Sieve size, mm	Percentage by mass passing	
80	100	-
63	98 - 100	-
40	90 - 99	100
31.5	-	98 - 100
20	25 - 70	90 - 99
10	-	25 - 70
4	0 - 15	0 - 15
2	0 - 5	0 - 5
1	-	-

Notes  
1. Typically 4/20 is the preferred material grading.

**Table 2**  
Coarse Graded Aggregate - Physical Property Requirements  
[Referencing BS EN 7533-13:2009, Annex A]

Property	Category to BS EN 13242 or BS 12630
Grading and oversize categories	G <sub>C</sub> 85 - 15
Category for tolerances at mid-size sieves	GT <sub>C</sub> 20 / 17.5
Category for maximum fines content	f <sub>d</sub>
Shape	FL <sub>30</sub>
Resistance to fragmentation	LA <sub>30</sub>
Resistance to wear	M <sub>DE</sub> 20
Durability:	
- Water absorption	WA <sub>2</sub> 2
- Magnesium sulphate soundness	MS <sub>18</sub>
Acid-soluble sulphate content:	
- Other than air-cooled blast-furnace slag	AS <sub>2</sub> 2
- air-cooled blast-furnace slag	AS <sub>1,0</sub>
Total sulfur:	
- Other than air-cooled blast-furnace slag	≤ 1% by mass
- air-cooled blast-furnace slag	≤ 2% by mass
Volume stability of slag:	
- air-cooled blast-furnace slag	Free from dicalcium silicate and iron disintegration V <sub>5</sub>
- steel slag	

Notes  
1. Blast furnace slag and other recycled materials should meet the requirements of the Environment Agency Waste Acceptance Criteria (given in Guidance for waste destined for disposal in landfills) for inert waste when tested in accordance with BS EN 12457-3:2002

**KEY**

- Red dashed line: Deck waterproofing system/ Impermeable geomembrane
- Green dashed line: Deck waterproofing system protective layer
- Blue dashed line: Permavoid Permatex Capillary Geotextile

- NOTES**
- All dimensions in millimetres, unless otherwise stated.
  - All dimensions are nominal and may vary within manufacturing or construction tolerances.
  - All site temporary and enabling works by others.
  - Polypipe products to be installed in accordance with Polypipe Civils recommendations, giving due consideration to the requirements of the approving organisation(s) and the ultimate owner of the installation.
  - This drawing is intended for guidance only. All proposed installations should be assessed in the context of the site and expected operational conditions, in addition to the overall site drainage scheme, prior to commencement of final design or construction activities.
  - All construction activities shall be executed by competent personnel in accordance with all relevant legislation, regulations, standards or codes of practice.

All information in this document is of an illustrative nature and is supplied by Polypipe Civils without charge. Polypipe may modify and change the information, products and specifications from time to time for a variety of reasons, without prior notice. Updates will not be issued automatically. This information is not intended to have any legal effect, whether by way of advice, representation or warranty (express or implied). We accept no liability whatsoever (to the extent permitted by law) if you place any reliance on this document you must do so at your own risk. The information within this document should not be solely relied upon to determine the suitability or installation requirements of our products for a proposed application and expected site conditions; expert advice should be sought in this respect. Copyright © 2018 Polypipe. All rights reserved. Polypipe logo is a registered trademark of Polypipe. All Polypipe products are protected by Design Right under UKPA 1988.

<p>Polypipe Civils North Road, Loughborough Leicestershire, LE11 1LE Tel: 01509 615100 Fax: 01509 615215 www.polypipe.com/civils</p>	<p>PROJECT: POLYPIPE PERMAVOID PODIUM DECK/ ROOF SYSTEM</p> <p>DRAWING TITLE: INVERTED ROOF TYPICAL CONSTRUCTION DETAILS</p>	<p>SHEETS FOR INFORMATION</p> <p>SHEET NO. 1 of 1</p> <p>DATE: 10/07/2018</p> <p>DRAWING NO. PD-IR-SD-100</p>
	<p>SCALE: NTS</p>	<p>AMENDMENT</p>